

ifm electronic

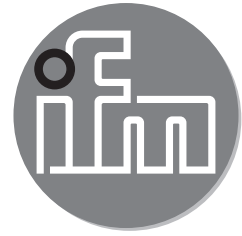

Installation instructions  
Hydraulic cylinder sensor

**efector120**<sup>®</sup>

**MFH / M9H**

**UK**

MFHxxx / 00 07 / 2015

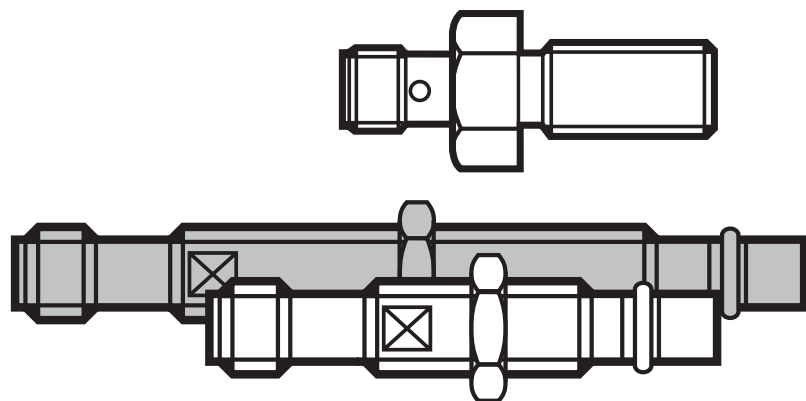



# 1 Preliminary note

## 1.1 Symbols used

► Instruction

→ Cross-reference

 Important note  
Non-compliance may result in malfunction or interference.

 Information  
Supplementary note.

## 2 Functions and features

The sensor detects ferromagnetic metals (FE metals) without contact and indicates their presence by a switching signal.

## 3 Installation

### 3.1 MFH

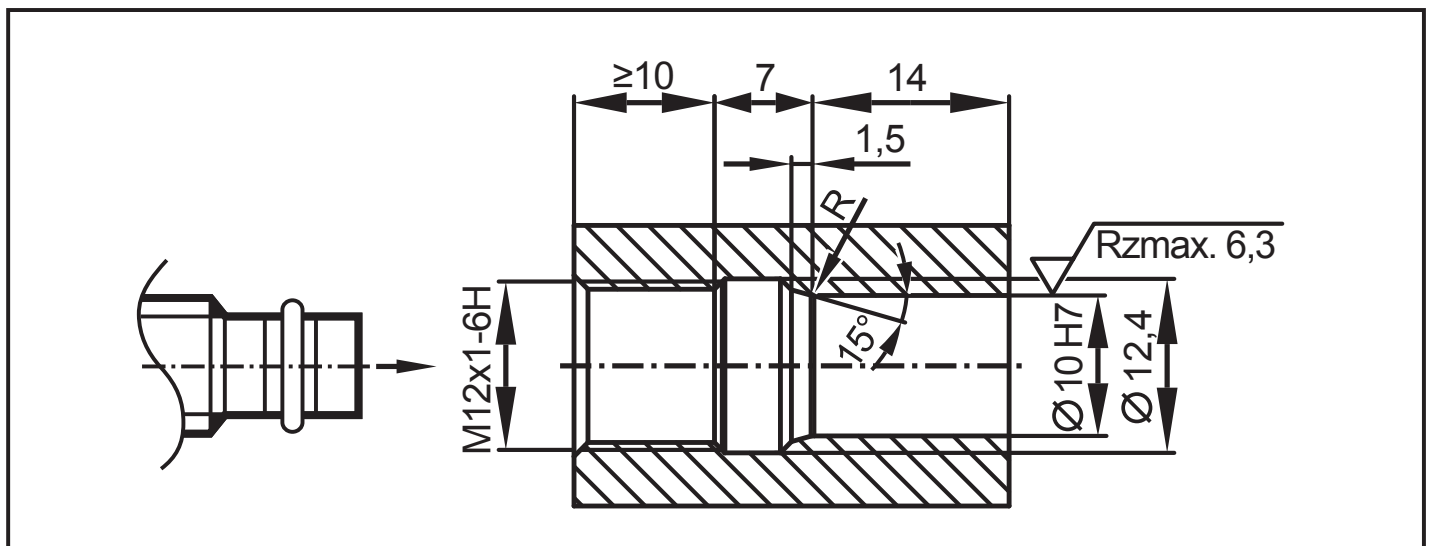

- ▶ Make sure that the piston rod is in the end position to be detected.
- ▶ Screw the sensor up to the end stop.
- ▶ Unscrew the sensor half a turn (~ 0.5 mm) to avoid mechanical damage.
- ▶ Tighten the nut.

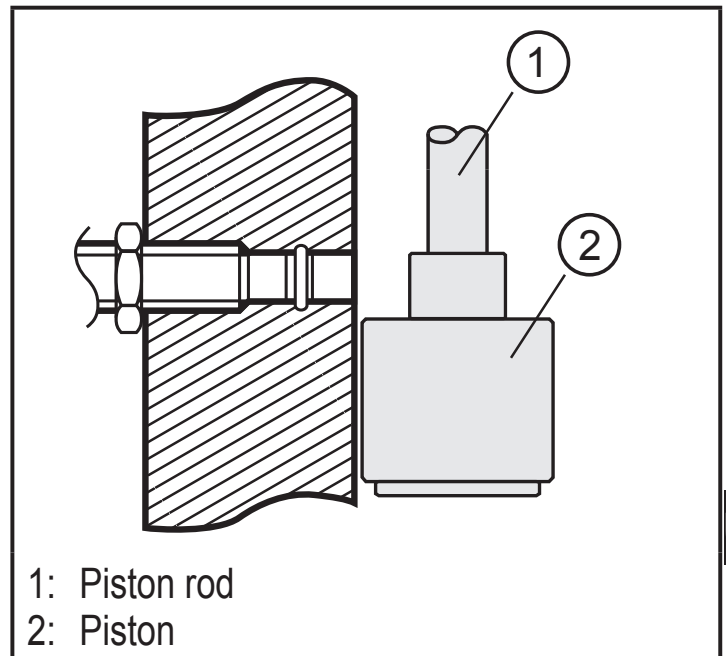

UK

### 3.2 M9H

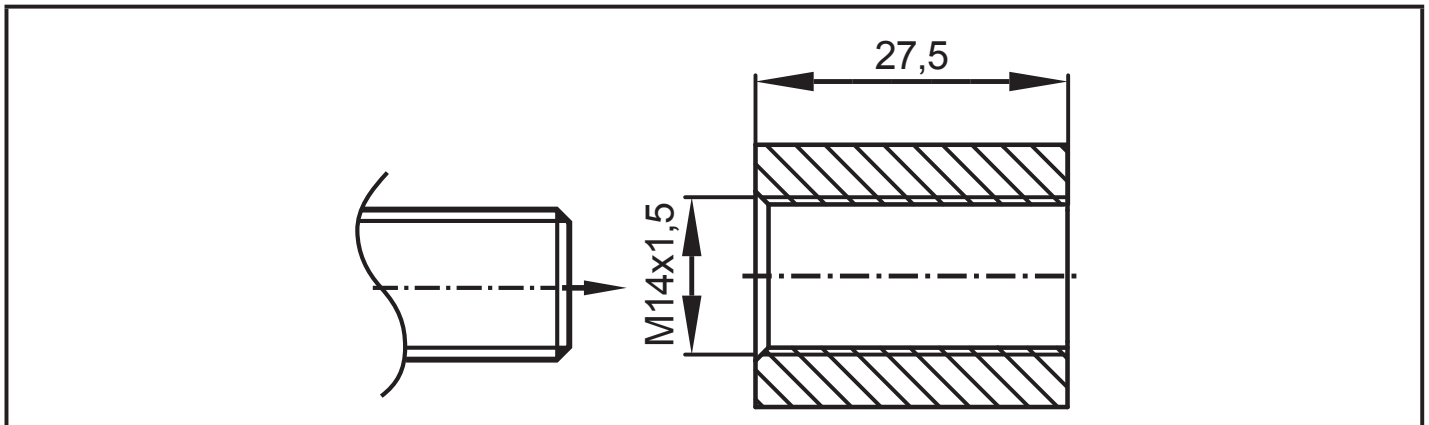

- ▶ Screw the sensor into an M14 thread.
- ▶ Tighten firmly.

## 4 Electrical connection



The sensor must be connected by a qualified electrician.

Observe the national and international regulations for the installation of electrical equipment.

- ▶ Disconnect power.
- ▶ Connect the unit as specified in the data sheet.

More information at [www.ifm.com](http://www.ifm.com)