

Mechanical position switch  
**BNS 819-FE-60-101-FD**  
**BNS00P**

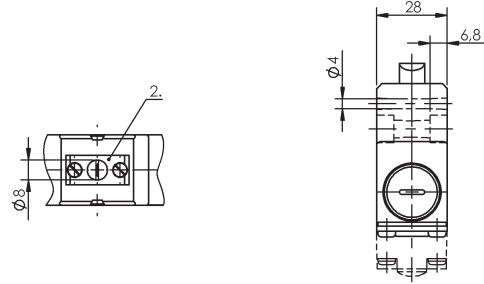

1) Reference edge 2) Anti-crystall. plunger 3) Function indicator FD/FE/LL

- Mech. single position
- Snap contact
- Chisel with wiper

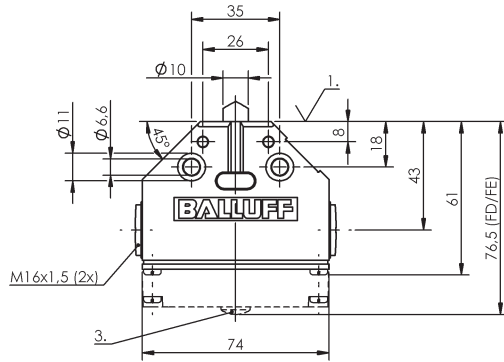

**General attributes**

Additional features	None
Approvals / Conformity	CE CCC
DIN switch	DIN 43693
Enclosure Type per IEC 60529	IP67
Function indicator	1st pos.: FD - 6...60 V

**Electrical attributes**

Continuous current	1st pos.: 6 A
Effective operating voltage U <sub>e</sub>	1st pos.: 250 V AC
Switching function mech.	Galvanically isolated One NO and one NC Dual output function

**Mechanical attributes**

Ambient temperature T <sub>a</sub> max.	85 °C
Ambient temperature T <sub>a</sub> min.	-5 °C
Approach direction	In either axis to mtg. surface
Approach speed	1st pos.: 30 m/min
Connection	1. screw terminal
Connector	None
Contact material	1st pos.: silver, gold plated

**Depth**

Dist. cam to reference edge	76.5 mm
Flange feedthrough	1st pos.: 5 - 0.5 mm
Height (H)	None
Housing finish	28.0 mm
Housing material	Eloxal
Mech. installation condition	Aluminum
Mechanical life expectancy	Any
No. of switch positions	1st pos.: 30 mil. operations
Operating principle	1 ST
Plgr. dist. 1st switch pos.	1st pos.: mechanical
Plunger block	14 mm
Plunger diameter	No
Plunger material	8.0 mm
Plunger style	1st pos.: stainless steel
Spacing (T)	1st pos.: E-Chisel
Style	None
Switching element	F 60 EGT
Switching operation force	1st pos.: BSE 30.0
Switching rate	1st pos.: min. 20 N
Type	1st pos.: max. 300/min
Version	Mech. single position
Width	Snap contact

Depth	76.5 mm
Dist. cam to reference edge	1st pos.: 5 - 0.5 mm
Flange feedthrough	None
Height (H)	28.0 mm
Housing finish	Eloxal
Housing material	Aluminum
Mech. installation condition	Any
Mechanical life expectancy	1st pos.: 30 mil. operations
No. of switch positions	1 ST
Operating principle	1st pos.: mechanical
Plgr. dist. 1st switch pos.	14 mm
Plunger block	No
Plunger diameter	8.0 mm
Plunger material	1st pos.: stainless steel
Plunger style	1st pos.: E-Chisel
Spacing (T)	None
Style	F 60 EGT
Switching element	1st pos.: BSE 30.0
Switching operation force	1st pos.: min. 20 N
Switching rate	1st pos.: max. 300/min
Type	Mech. single position
Version	Snap contact
Width	74 mm