



Model Number

GL40-IR/32/40a/98a

Photoelectric slot sensor with 3-pin, M8 x 1 connector

Features

- Optimized for the detection of small parts
- High switching frequency
- Multiple device installation possible, no mutual interference (no cross-talk)
- Sensitivity adjuster and light/dark switch as standard features of this series
- Infrared light
- Degree of protection IP67
- cULus approval
- Sturdy aluminum housing

Product information

Photoelectric slot sensors offer vast installation benefits thanks to their housing design. When it comes to operation, these new generation devices boast features such as high resolution, high repeatability, automatic signal threshold adjustment, ambient light resistance, and detection of and/or light transmission through transparent objects. Cross-talk protection enables parallel installation of devices despite extremely high switching frequency. These characteristics guarantee reliable detection of small parts, from 0.3 mm, across the entire detection range, even in very fast moving applications.

Dimensions

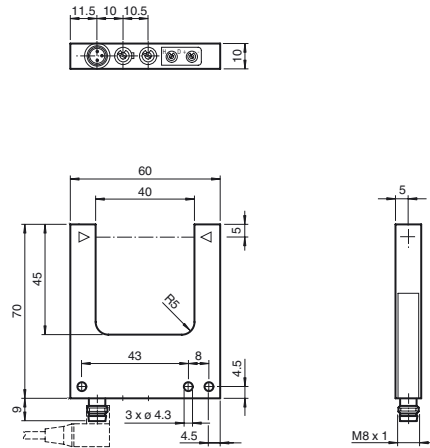

Electrical connection

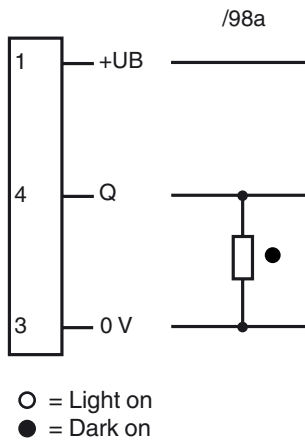

Pinout

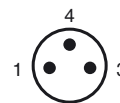

Indicators/operating means

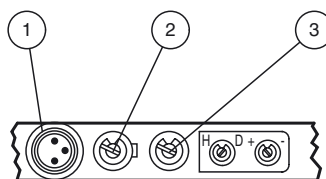

| | | |
|---|----------------------|-----|
| 1 | Functional display | red |
| 2 | Light-/dark switch | |
| 3 | Sensitivity adjuster | |

Release date: 2015-02-27 09:18 Date of issue: 2015-02-27 21:5057_eng.xml

Refer to "General Notes Relating to Pepperl+Fuchs Product Information".

Pepperl+Fuchs Group
www.pepperl-fuchs.com

USA: +1 330 486 0001
fa-info@us.pepperl-fuchs.com

Germany: +49 621 776 4411
fa-info@de.pepperl-fuchs.com

Singapore: +65 6779 9091
fa-info@sg.pepperl-fuchs.com

Technical data**General specifications**

| | |
|---------------------|--------------------------|
| Light source | IRE D |
| Light type | modulated infrared light |
| Tests | EN 60947-5-2 |
| Target size | 0.3 mm |
| Slot width | 40 mm |
| Ambient light limit | 100000 Lux |

Indicators/operating means

| | |
|--------------------|---|
| Function indicator | LED red in connector |
| Control elements | Sensitivity adjuster, light/dark switch |

Electrical specifications

| | | |
|------------------------|-------|-------------------------|
| Operating voltage | U_B | 10 ... 30 V DC, class 2 |
| Ripple | | 10 % |
| No-load supply current | I_0 | ≤ 15 mA |

Output

| | | |
|---------------------|--|----------|
| Switching type | light/dark on | |
| Signal output | 1 PNP, short-circuit protected, open collector | |
| Switching voltage | max. 30 V DC | |
| Switching current | max. 100 mA | |
| Repeat accuracy | 0.05 mm | |
| Switching frequency | f | 2 kHz |
| Response time | | ≤ 250 μs |

Ambient conditions

| | |
|---------------------|-------------------------------|
| Ambient temperature | -20 ... 60 °C (-4 ... 140 °F) |
| Storage temperature | -20 ... 75 °C (-4 ... 167 °F) |

Mechanical specifications

| | |
|----------------------|-------------------------|
| Degree of protection | IP67 |
| Connection | M8 connector, 3-pin |
| Material | |
| Housing | black anodized aluminum |
| Optical face | glass |
| Mass | 45 g |

Approvals and certificates

| | |
|---------------|--|
| CE conformity | CE |
| UL approval | cULus |
| CCC approval | CCC approval / marking not required for products rated ≤36 V |

Accessories**V3-GM-2M-PUR**

Cable socket, M8, 3-pin, PUR cable

V3-WM-2M-PUR

Cable socket, M8, 3-pin, PUR cable

Other suitable accessories can be found at www.pepperl-fuchs.com