



Model Number

PMI104-F90-IE8-V15

Features

- Analog output 4 mA ... 20 mA
- Adjustable switch points
- Measuring range 0 ... 104 mm

Technical data

General specifications

Switching element function	Analog current output with PNP binary NO
Object distance	0.5 ... 3 mm , recommended: 2 mm
Measurement range	0 ... 104 mm
Linearity range	1 ... 103 mm

Nominal ratings

Operating voltage U_B	18 ... 30 V DC
Reverse polarity protected	reverse polarity protected
Linearity error	within measuring range: ± 0.8 mm within linearity range: ± 0.4 mm

Repeat accuracy	± 0.1 mm
Resolution	125 μ m
Temperature drift	± 0.5 mm (-25 °C ... 70 °C)
No-load supply current I_0	≤ 40 mA
Operating voltage display	LED green

Functional safety related parameters

MTTF _d	280 a
Mission Time (T_M)	20 a
Diagnostic Coverage (DC)	0 %

Switching output

Output type 2 switch outputs PNP, NO , reverse polarity protected , short-circuit protected

Operating current I_L	≤ 100 mA
Switching window	± 1 mm
Switching hysteresis	0.4 mm
Voltage drop	≤ 3 V
Short-circuit protection	pulsing

Analog output

Output type	1 current output: 4 ... 20 mA
Load resistor	$\leq 400 \Omega$

Ambient conditions

Ambient temperature	-25 ... 70 °C (-13 ... 158 °F)
---------------------	--------------------------------

Mechanical specifications

Connection type	M12 x 1 connector, 5-pin
Protection degree	IP67
Material	
Housing	ABS
Target	structural steel, e. g. 1.0037, SR235JR (formerly St37-2)

Compliance with standards and directives

Standard conformity	
Standards	EN 60947-5-2:2007 IEC 60947-5-2:2007

Approvals and certificates

UL approval	cULus Listed, General Purpose, Class 2 Power Source
CCC approval	Products with a maximum operating voltage of ≤ 36 V do not bear a CCC marking because they do not require approval.

Dimensions

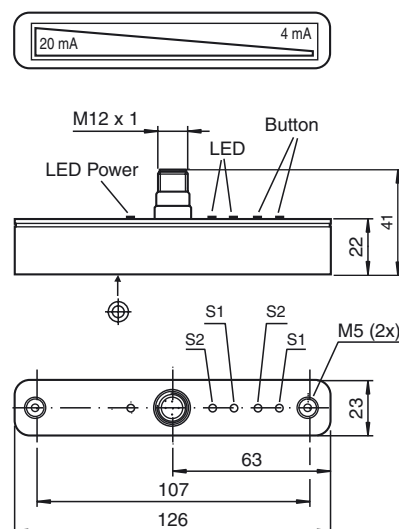

Electrical Connection

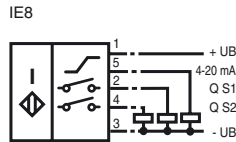

Pinout

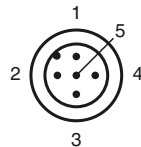

Wire colors in accordance with EN 60947-5-2

1	BN	(brown)
2	WH	(white)
3	BU	(blue)
4	BK	(black)
5	GY	(gray)

Additional Information

dimensions for the target object:

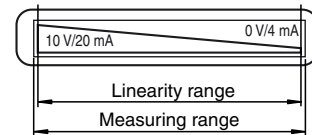
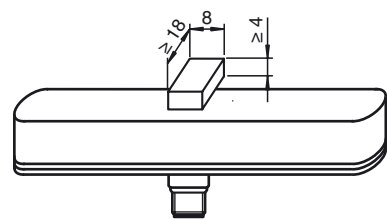

Accessories

BT-F90-W

Damping element for F90 sensors; lateral screw holes

MH-F90

Mounting bracket for mounting of F90 sensors

V15-G-2M-PVC

Cable socket, M12, 5-pin, PVC cable

V15-W-2M-PVC

Cable socket, M12, 5-pin, PVC cable

Operating instructions

• **Safety information**



This product may not be used in applications where personal safety depends on the function of the device. This product is not a safety component as described in EU Machinery Directive.

• **Sensor versions**

The F90 linear position measurement system is available in 2 versions. In the PMI...-F90-IU-V1 version, the position measuring system transmits current and voltage signals proportional to the position of the damping element at the outputs. The PMI...-F90-IE8-V15 version offers a current signal as well as the option of teaching in two switching points directly at the sensor independently of one another at the press of a button, which is then indicated on two switching outputs. Two additional LEDs indicate the output states of the two switching outputs.

Version PMI...-F90-IU-V1

Output signals: 4 mA ... 20 mA and 0 V ... 10 V



Only the current output or the voltage output may be used. The unused output must remain load free.

Version PMI...-F90-IE8-V15

Output signals: 4 mA ... 20 mA and 2 programmable switching amplifiers

• **Programming the PMI...-F90-IE8-V15**

The rear of the PMI...-F90-IE8-V15 sensor has two small, slightly recessed push buttons for programming the switching points. The buttons are marked "teach in" and S1 for switching point S1 and S2 for switching point S2.

To teach in a switching point, proceed as follows:

- The position detection damping element must be placed at the relevant position, i.e. the switching point that you wish to teach in.

Release date: 2012-05-30 16:55 Date of issue: 2012-05-30 191138_eng.xml

- Press the corresponding push button for at least two seconds.
The associated switching state LED starts flashing to indicate that the sensor is now in "teach mode".
- Press the button again to confirm the relevant switching point.
The switching state LED then lights up constantly as long as the damping element is not moved.

The switching point is now taught in and the associated switching point changes to an active state within an actuator adjustment range of ± 1 mm around the taught switching point.



Note

If the switching point is not confirmed within 80 seconds, the sensor exits "teach mode" and continues operation with the previous values.

Damping element

The linear position measurement system is adapted perfectly to the geometry of the damping elements offered in our product range.



Note

When using other damping elements, always make sure that the active surface of the damping element has a width of exactly 8 mm and covers the entire width of the sensor.

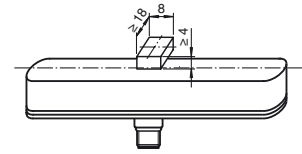

Installation and operation

Instructions on installation

- Flush installation is possible
- to extend the measuring range, units from the -F90 linear position measurement system can be connected in series (both behind and adjacent to one another) without a minimum distance.
- The minimum distance between the measuring field (framed area on the sensor front) and mounting base or mounting elements on the damping element must be 3 mm.

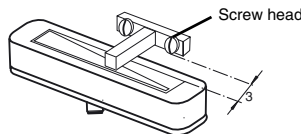
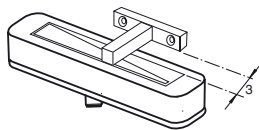
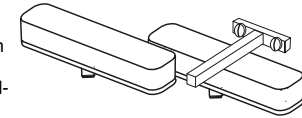

Operating information

The specified measurement accuracy is achieved with an actuator distance of 1 to 3 mm.

If the damping element leaves the measuring area (illustration below):

- the last valid value is retained at the voltage output (PMI...-F90-IU-V1 only) until the damping element enters the valid area again.
- the last valid value is retained for 0.5 seconds at the current output (all types). The output then switches to a fault current of 3.6 mA until the damping element enters the valid area again.
- the switching amplifiers set to basic state after 0.5 seconds ("normally open").

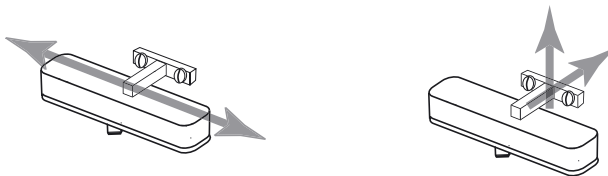

Defining the measuring range / measured position

The measured position of the damping element (actuator) is based on half of the width (center of the actuator). The measuring range starts and finishes when half the width of the actuator covers the measurement field marked on the sensor when the actuator makes a longitudinal movement (see left illustration above).

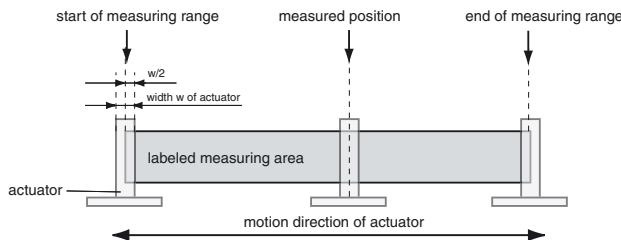

Accessories

Damping elements

BT-F90-W



Mounting bracket

MH-F90



Straight cable:

V1-G-2M-PVC (4-wire)

V15-G-2M-PVC (5-wire)

Angled cable:

V1-W-2M-PVC (4-wire)

V15-W-2M-PVC (5-wire)